

ANNEXURE C FLOOR PLAN

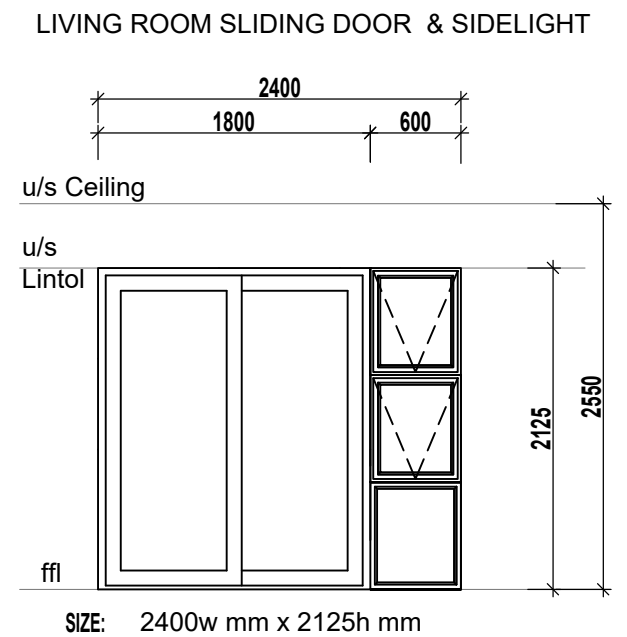
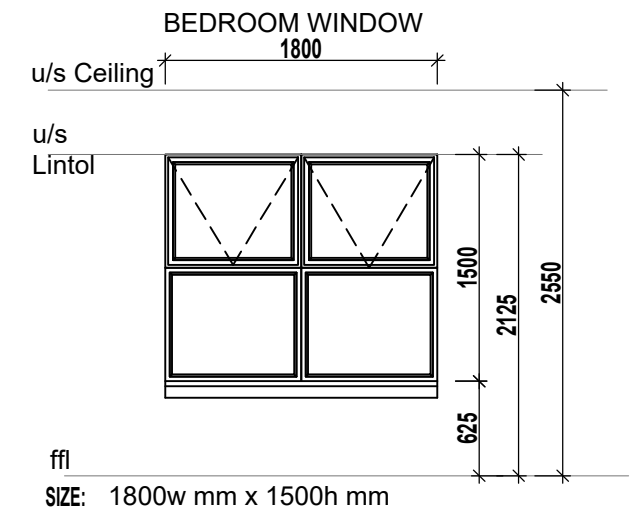
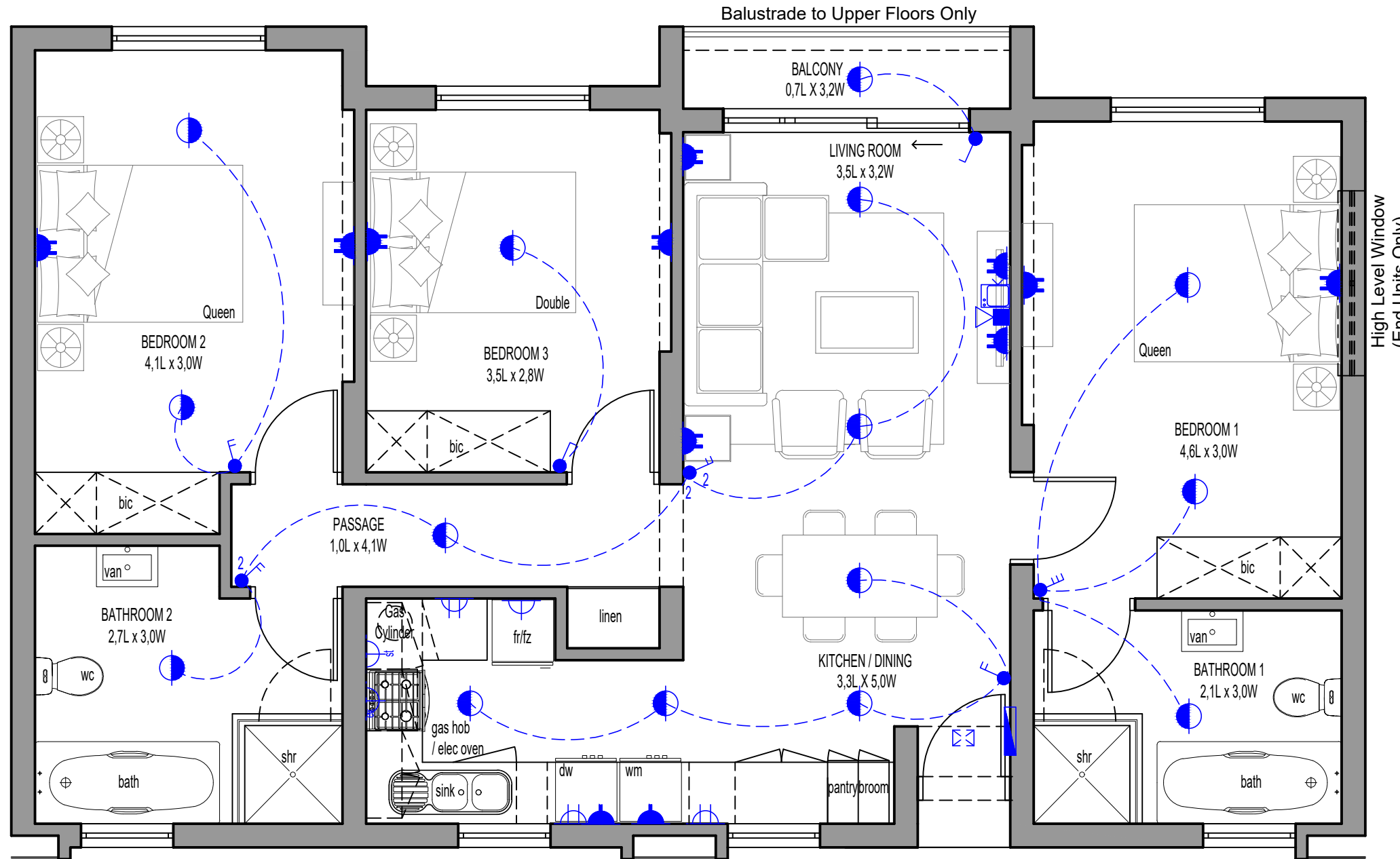

3 Bedroom - 2 Bathroom

SCALE 1:50

E2

ELECTRICAL LEGEND

- | | | | | | |
|--|---|--|---|--|--------------------------------|
| | Surface Mounted LED Fitting | | Single Plug Point (300mm Above FFL) | | Distribution Board |
| | External Wall Mounted LED Light Fitting | | Double Plug Point (300mm Above FFL) | | TV Point |
| | Single Light Switch | | Single Plug Point (150mm Above Counter) | | Fibre / Data Point |
| | Double Light Switch | | Double Plug Point (150mm Above Counter) | | Inverter (Above Entrance Door) |
| | Triple Light Switch | | Stove Isolator (Above Counter) | | |
| | Two-Way Light Switch | | Extractor Plug (High Level) | | |

AREA

TYPE E2	
Floor Area	98.47 m ²
Balcony	2.84 m ²
TOTAL	101.31 m²

* The areas are approximate and shall vary from the areas reflected on the sectional title plan