

# ANNEXURE C FLOOR PLAN

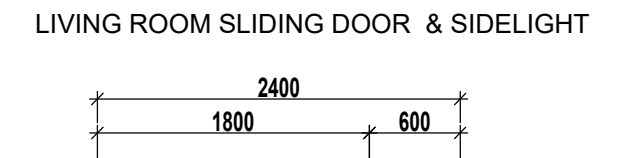
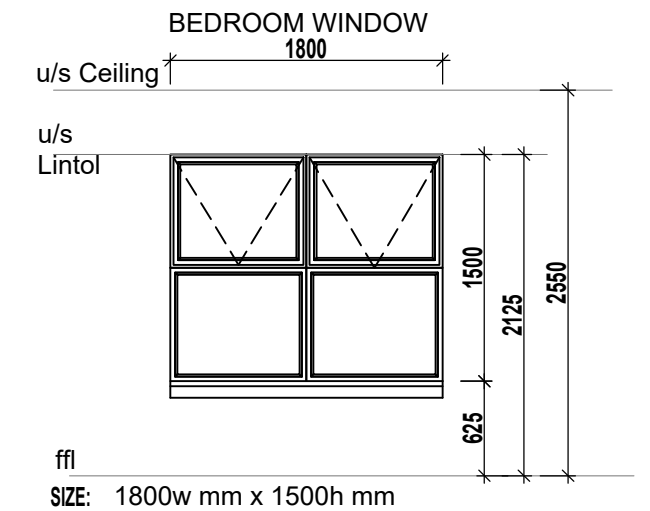
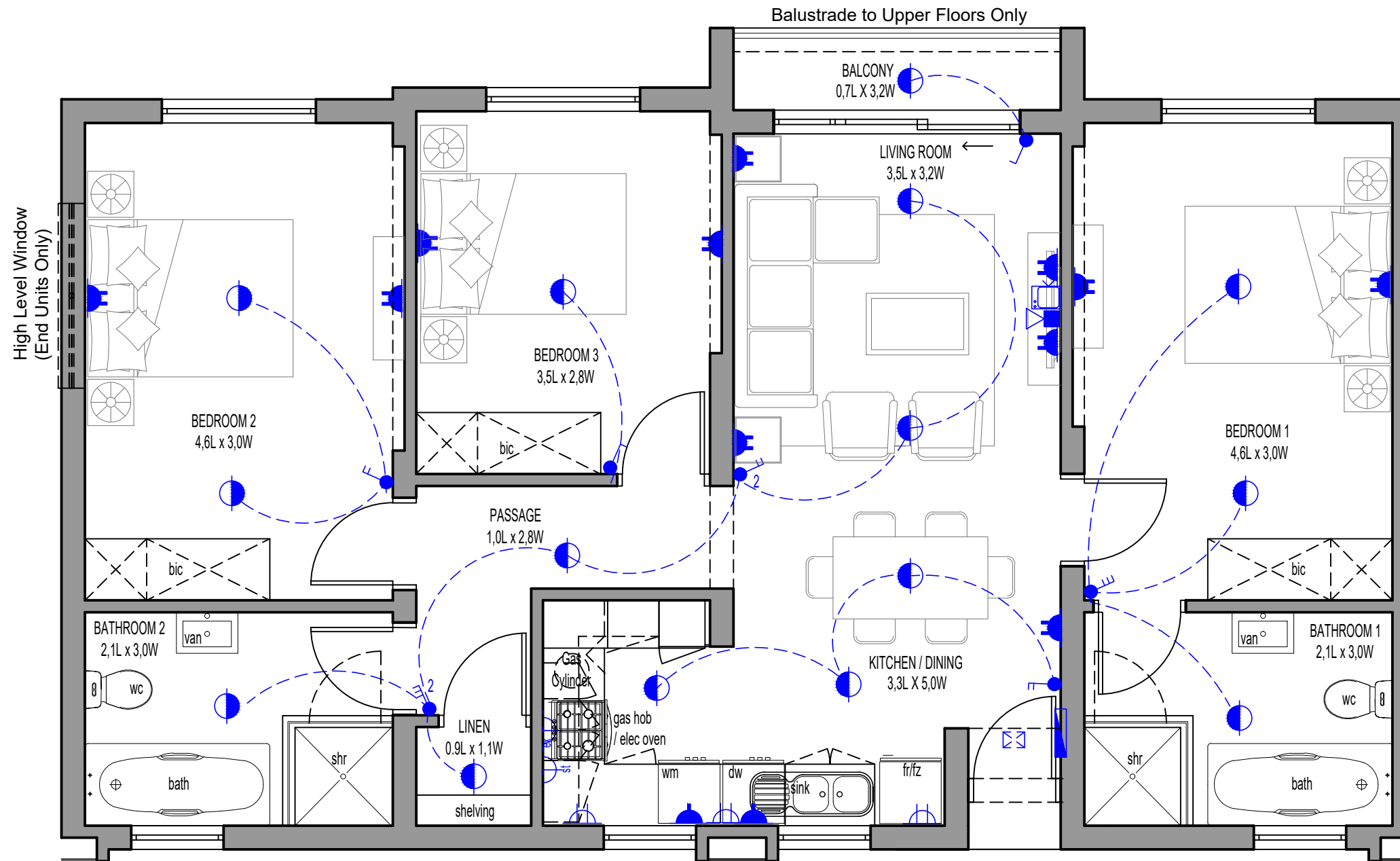

## 3 Bedroom - 2 Bathroom

SCALE 1:50

### ELECTRICAL LEGEND

- |  |   |  |   |  |                                |
|--|---|--|---|--|--------------------------------|
|  | Surface Mounted LED Fitting             |  | Single Plug Point (300mm Above FFL)     |  | Distribution Board             |
|  | External Wall Mounted LED Light Fitting |  | Double Plug Point (300mm Above FFL)     |  | TV Point                       |
|  | Single Light Switch                     |  | Single Plug Point (150mm Above Counter) |  | Fibre / Data Point             |
|  | Double Light Switch                     |  | Double Plug Point (150mm Above Counter) |  | Inverter (Above Entrance Door) |
|  | Triple Light Switch                     |  | Stove Isolator (Above Counter)          |  |                                |
|  | Two-Way Light Switch                    |  | Extractor Plug (High Level)             |  |                                |

### AREA

|              |                            |
|--------------|----------------------------|
| TYPE E1      |                            |
| Floor Area   | 96.10 m <sup>2</sup>       |
| Balcony      | 2.84 m <sup>2</sup>        |
| <b>TOTAL</b> | <b>98.94 m<sup>2</sup></b> |

# E1

\* The areas are approximate and shall vary from the areas reflected on the sectional title plan